



Key Features

- Intel gen 8/9th Coffee lake-R LGA1151 CPU+Q370 PCH
- Dual channel 4xDDR4 2666/2400MHz DIMM, up to 128GB
- Intel UHD Graphic, 2xDP+1xHDMI three independent display
- 1xI219LM Gig. Ethernet+2xI210AT Gig. Ethernet
- 6xUSB3.1, 7xUSB2.0 (two front and one built-in), Audio out and Mic
- 2xRS232/422/485, 2xRS232, 8 bit DIO
- 1xPCIeX16 or 2xPCIeX8+2xPCIeX4
- 1xMini PCIe with a SIM card slot, 1xM.2 2280 M-Key
- 4x3.5 "SATA3.0 shock resistant and anti-vibration hard disk bay
- Standard 19" 4U rackmount chassis with high efficiency air cooling design
- Standard PS2 ATX power supply,300/500/750/1000W

Description

PADR-S501-961 is a standard 19" 4U rackmount industrial computer with an Intel Q370 chipset powered by Intel® gen 8/9th Coffee lake-R LGA1151 series CPU. Rich functional IO, 4 PCIe expansion capabilities, excellent air cooling design, power consumption ladder ATX power supply selection, suitable for machine vision, CNC machine tools and factory production line automation and other fields.

I/O View

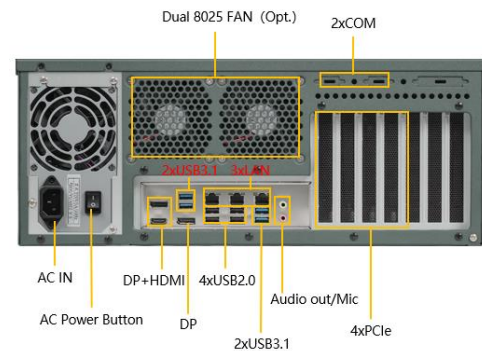
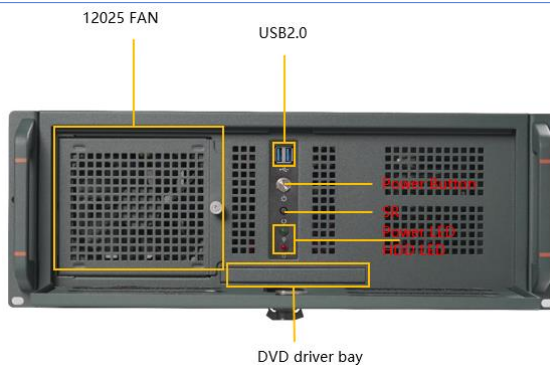

SPEC.

CPU+PCH	Intel® gen 8/9th Coffee-S Core i9/i7/i5/i3 LGA1151 CPU, up to 95W, Q370 chipset
Memory	4x288-pin Non-ECC DIMM , dual channel DDR4 2400/2666MHz, up to 128GB
Expansion	1xFull size Mini PCIe (PCIe X1+USB) with SIM slot; 1xM.2 2280 M-Key(Gen3, PCIeX4 signal) 2xPCIe X16 slot (PCIe Gen3, support 1xPCIeX16 device, when connecting 2 devices, it automatically switches to 2xPCIe X8) 2xPCIe X8 slot (PCIe Gen3, 2xPCIe X4 signal)
Graphics	Intel UHD Graphics, Supports DirectX* 12, OpenGL 4.5 HDMI max. res. 4096*2304@24Hz, DP max. res. 4096*2304@60Hz, supports three independent displays
Audio	Realtek ALC662VD controller, Support 5.1 channel
LAN	2xIntel I210AT, 10M/100M/1000M self-adapt, support WOL 1xIntel I219LM, 10M/100M/1000M self-adapt, support WOL, supports AMT12.0 and iVpro
Storage	4xSATA3, 6.0Gbps interface, the box is designed with 4x3.5 "and 2x2.5" 5 anti-vibration hard disk bay, 1 ultrathin DVD driver bay, can realize multi-category combined storage
Rear I/O	3xLAN(RJ45); 1xHDMI+2xDP; 1xLine out+1xMic 2x3.5mm phone jack 4xUSB3.1 Gen2 (10Gb/s, Type A), 4xUSB2.0(Type A); 2xRS232/422/485 (DB9 male)
Front I/O	2xUSB2.0(Type A)
Internal I/O	8bit DIO, 1xUSB2.0(Type A), 2xRS232 pin header, 2xUSB3.1 Gen2, PS/2 wafer, the built-in interface can be elicited through an extension window
Switch & LED	Front with Power Button, Reset Button, Power LED, HDD LED, on board with USB Power jumper, AT/ATX jumper, Clear CMOS jumper
Power Supply	AC100-240V input, standard ATX power supply 300W, optional 500W、750W and 1000W; TDP: TBD
Watchdog Timer	Watchdog timeout programmable via software 1 to 255 second
Security	Support Infineon TPM2.0(Opt.)
OS Support	Windows* 10 Enterprise & IOT Enterprise (64-bit) (CFL-R) Windows* Server 2016 (Intel® Xeon® E) Ubuntu*、SuSe*、Redhat Enterprise* 1,2 (Kernel 4.14) (CFL-R) Wind River* VxWorks* 7 (CFL-R)

Structure and Mounting	Door with lock design, SGCC steel plate, metal mold molding; Mounted on 19" rack, optional mounting rail set
Cooling	Linear airflow design, front 12025 ball bearing fan, optional 2 rear 8025 ball bearing fan
Color	Granite grey
Dimension	(W*H*D): 430x470x173mm
Height	14.0kg
Operating Temperature	0 ~ 50°C
Storage Temperature	-40°C~70°C
Storage Humidity	10~95%@40°C, Non-condensing
Vibration	5grms/5~500Hz/random/in working (SSD); 1grms/5~500Hz/random/in working (HDD)
Shock	50g peak acceleration(11ms duration)(SSD); 20g peak acceleration(11ms duration)(HDD)
EMC/Certification	CE/FCC Class A, 3C

Dimension

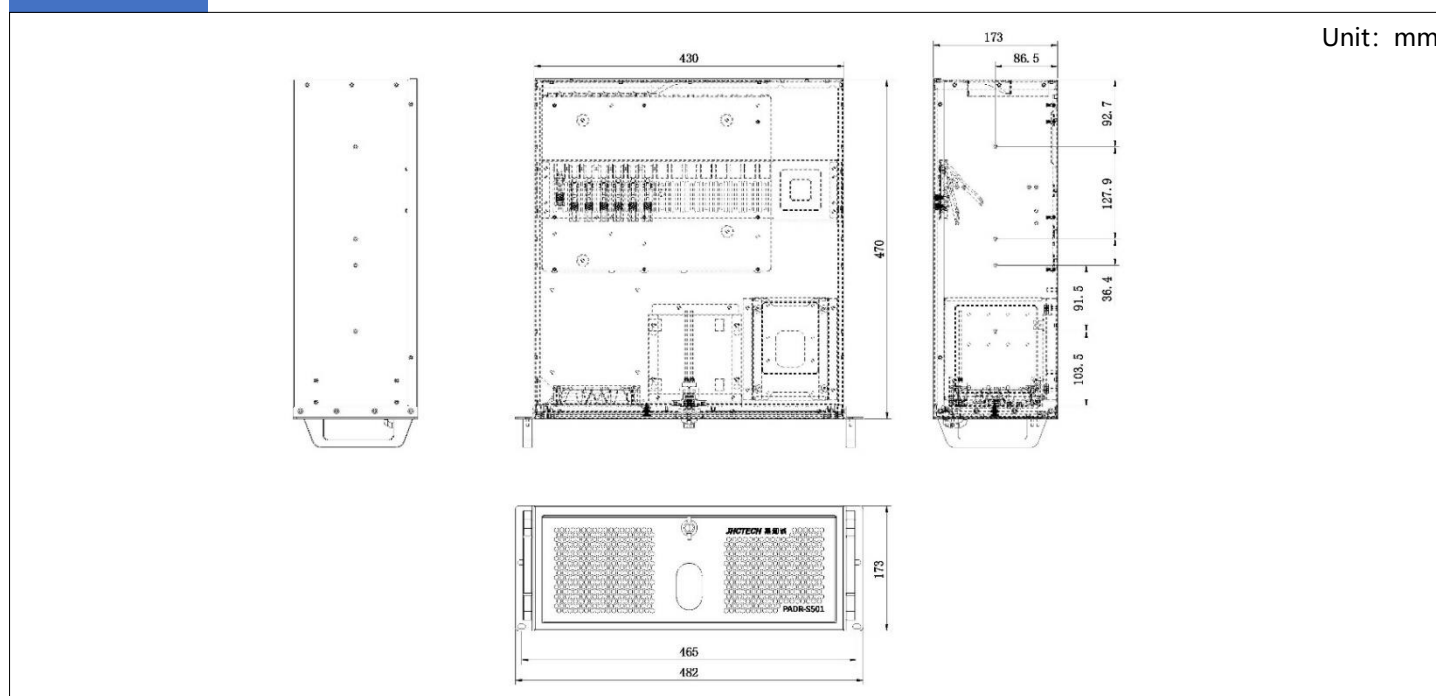

Ordering Info

Model No.	Introduction	Power
PADR-S501/961-300WP	Intel® Q370 PCH+Coffee lake-R LGA1151 CPU, 4xDDR4 DIMM, 3xLAN, 6xUSB3.1 (2 built-in), 7xUSB2.0 (1 built-in), 4xCOM, 1xMini PCIe, 1xM.2 2280 M-Key, 1xPCIe X16 (or 2xPCIeX8), 2xPCIeX4, 1xHDMI, 2xDP, 1xLine out and 1xMic, 4x3.5 "SATA bay.	AC 100-240V,ATX 300W
PADR-S501/961-500		AC 100-240V,ATX 500W
PADR-S501/961-750		AC 100-240V,ATX 750W
PADR-S501/961-1000		AC 100-240V,ATX 1000W

Accessory Pack

Standard Accessories	Amount	Optional Components	Optional Components
Screw jumper package	1	LGA115X, TDP 35-65W CPU WIND-COOL	A pair of guide rail mounting parts
Air Filter	1	LGA115X, TDP 95W CPU WIND-COOL	8025 Dual ball bearing DC 12V fans
AC power supply cabel	1	one 4pin to 2+6pin GPU power cable	DB9 male needle DIO cabel
		SATA 7pin data cable, length 420mm	